

duct panelling



overview

Duct panelling systems conceal unsightly services, protecting them from vandalism, whilst maintaining an easy method of access should the need arise.

full height

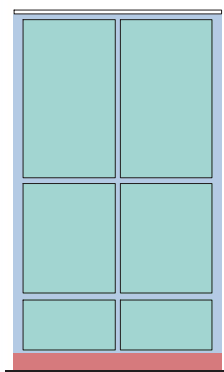
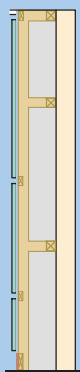

Suitable for WCs, urinals and wall hung wash hand basins, the amount and size of the panels in each set are manufactured to your requirements.

When choosing duct configuration, due consideration should be given to the size and weight of removable access panels for maintenance purposes.

 Shower panelling is also available manufactured with overlapping rebated horizontal edges to prevent direct ingress of water. This detail will require sealing on site by a specialist contractor.

low level

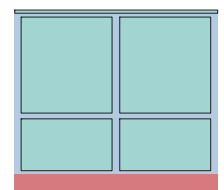
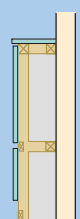

Low level ducts are available with the option of a removable lid/shelf panel.

panel fixings

Concealed 'lift off' or 'push fit' brackets are used to mount the panels to the framework. Larger panels can be hinged to allow safer access for maintenance.

Budget cylinder locks can also be provided for added security.

